

 **BURRIS**[®]

SPEEDBEAD

Installation Instructions

Winchester, Browning

Item 300258, 300257

- Winchester SX3
- Browning Gold 12 Ga
- Browning Silver Auto 12 Ga



**SpeedBead -
Winchester, Browning**
- Winchester SX3
- Browning Gold 12 Ga
- Browning Silver Auto 12 Ga

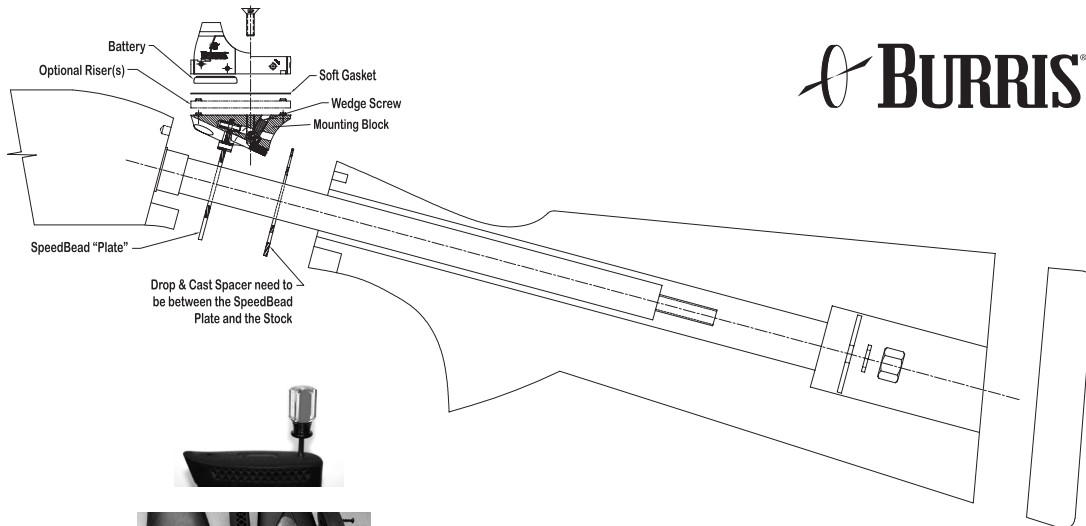

BURRIS®

1. Remove the butt pad. (Phillips Head)
2. Remove stock nut, plates & molded plate on synthetic stocks (13mm SX3 or 19mm deep socket for the Browning Silver)
3. Click SpeedBead on to front of stock over spacer, compress the foam to engage. Be sure any Cast-Cant spacer is between SpeedBead plate and stock.
4. Slide stock down over the rod and up to receiver.



5. Re-assemble stock plates and nut, and tighten stock, and SpeedBead firmly up against receiver. Be sure there are no gaps between the receiver plates and the stock.
6. Snug SpeedBead Mounting Block set screw with short wrench leg for leverage to prevent over tightening.
7. Replace Butt Pad.
8. Place the soft gasket on top of the mounting block, aligning the holes to the pins.
9. Insert the battery into the bottom of the FastFire Sight and mount the FastFire to the SpeedBead mount using the provided short screws and lock washers.



Sight Alignment

Turn on the FastFire sight. Use the provided screwdriver to FIRST loosen the FastFire lock screws, THEN, using the windage & elevation screws, adjust the Red Dot to be directly “on” the barrel bead. You will want to be looking down the barrel rib as if you were shooting the shotgun when you are making the adjust-



ments. (The SpeedBead system was designed such that the Red Dot will usually be viewed approximately 1/3 of the way up the glass window when sighted in to correspond with the shotgun’s normal bead. If you choose to utilize the provided spacers, the red dot should be aligned the same distance above the shotgun’s bead as the thickness of the spacer used.) Tighten the lock screws. You are probably real close to sighted-in. Finish zeroing at the range.

Operating Notes:

The SpeedBead system is virtually parallax free. No matter where in the window the Red Dot appears, it always is where the shot is going. Do not be concerned if the Red Dot is not in the center of the window when shooting. Just get the Red Dot where you want it in relation to the target and take the shot.

Spacers and longer screws are provided with your SpeedBead. The advantages of SpeedBead are increased with the SpeedBead window a little higher than the front bead because it allows you to see and lead rising targets faster and to engage them more accurately.

For additional information about the FastFire sight, see the included FastFire II booklet.